

EVOSTA 2 OEM

WET ROTOR ELECTRONIC CIRCULATORS



TECHNICAL DATA

Operating range: 0-4 m³/h with head up to 7,5 metres.

Pumped liquid temperature range: from -10 °C to +110 °C.
(130 °C to 60 °C ambient)

Working pressure: 10 bar (1000 kPa)

Protection class: IPX5

Insulation class: F

Installation: with horizontal motor axis

Standard power input: single-phase 1 x 230 V~ 50/60 Hz

Power cable: molex plug with 1.5m cable

Signal cable: plug with 1.5 m cable (OEM versions only)

Pumped liquid: Clean, free of solids and mineral oils, non-viscous, chemically neutral, with properties similar to water.
(max. glycol 50%)

MATERIALS

N.	PARTS	MATERIALS
1	STATOR LINER	AISI 316
2	IMPELLER	ULTRASON
3	SHAFT	ALUMINA
4	ROTOR	Fe
5	BUSH HOLDER	BRASS
6	BUSH	ALUMINA
7	THRUST BUSH	GRAPHITE
8	THRUST BOX	EPDM
9	BREATHING PLUG	BRASS
10	O-ring	EPDM
11	MOTOR CASING	AISI 304
12	ENCLOUSER SHELL	POLYCARBONATE
13	ENCLOUSER	POLYCARBONATE
14	ROTOR LINER	AISI 304
15	GASKET	EPDM
16	PUMP BODY	CAST IRON-BRONZE (SAN VERSION)
17	SEAL RING	AISI 304

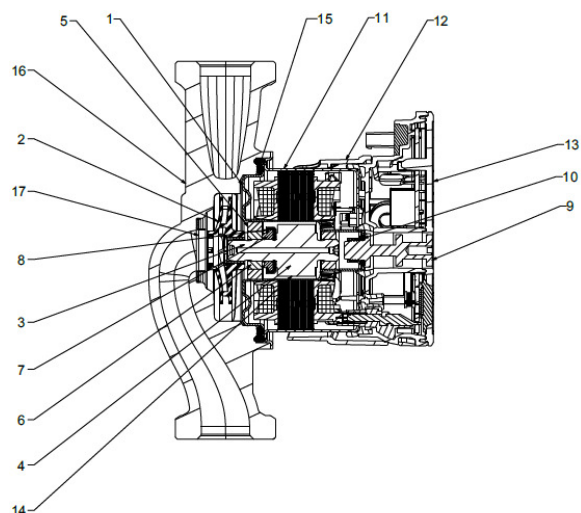

OPERATING MODES

PROPORTIONAL DIFFERENTIAL PRESSURE OPERATION

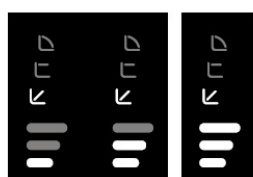

PP1

PP2

PP3

FIXED CURVE OPERATION

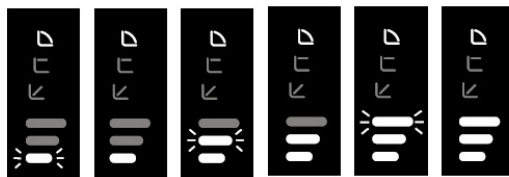

I

II

III

IV

V

VI

CONSTANT DIFFERENTIAL PRESSURE OPERATION

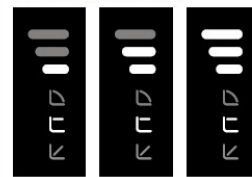

PC1

PC2

PC3

EVOSTA 2 OEM - ELECTRONIC CIRCULATORS FOR DOMESTIC HEATING AND AIR CONDITIONING SYSTEMS SINGLE, WITH UNIONS

Liquid temperature range: from -10°C to +110°C - Maximum operating pressure: 10 bar (1000 kPa)

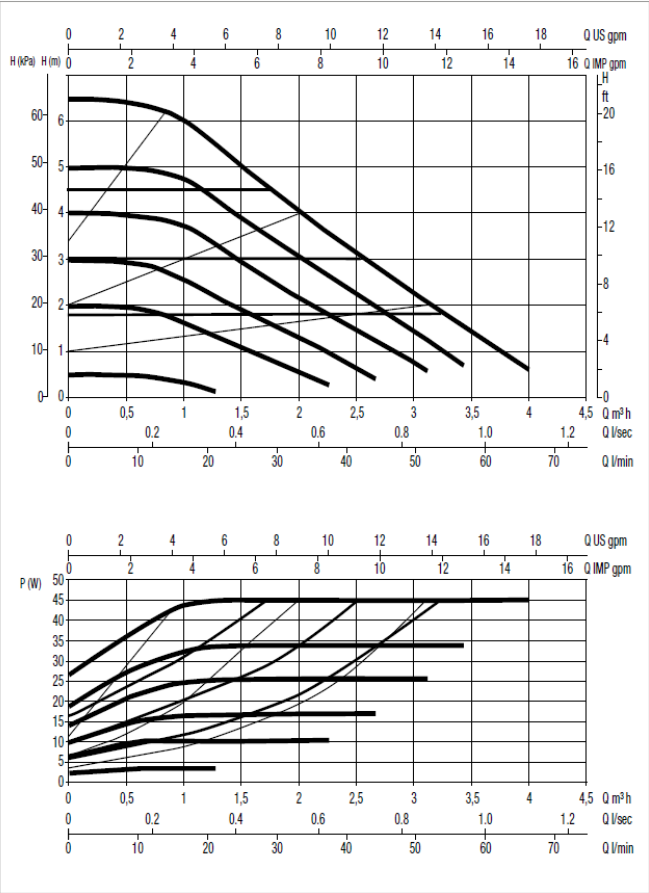
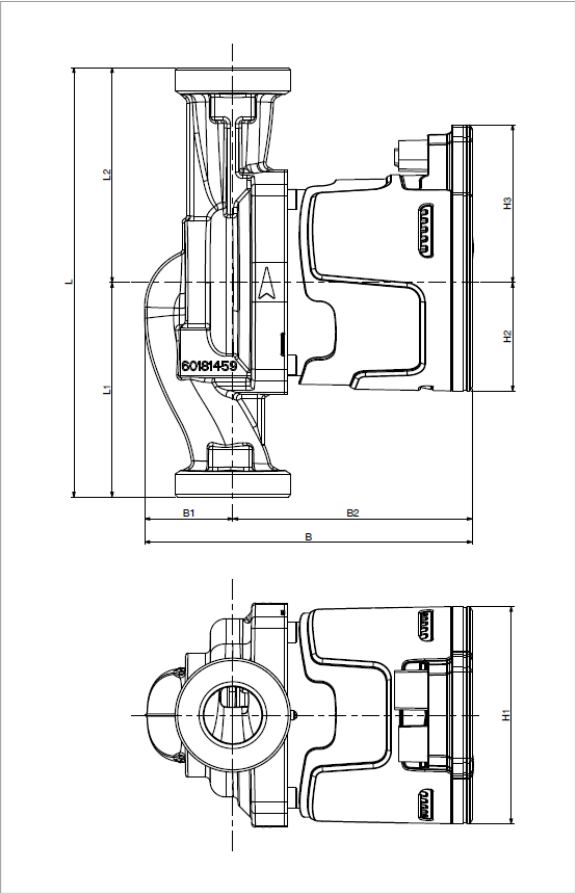

The performance curves are based on kinematic viscosity values = 1 mm²/s and density equal to 1000 kg/m³. Curve tolerance according to ISO 9906.

MODEL	CENTRE DISTANCE mm	POWER INPUT 50 Hz	P1 MAX W	P1 MIN W	In MAX A	In MIN A	EEI detail 3	GRADE IP
EVOSTA2 65/130 OEM (1")	130	1x230 V ~	45	2	0.35	0.026	<0,20	IP X5

MODEL	L	L1	L2	B	B1	B2	F	H	H1	H2	H3	Q.TY X PALLET
EVOSTA2 65/130 OEM (1")	130	65	65	135	36	99	1" 1/2	94	91	45.5	66	240